

# MOON CRESTA

**SERVICE INSTRUCTIONS**

1. Name of Each parts (D.1, 2)

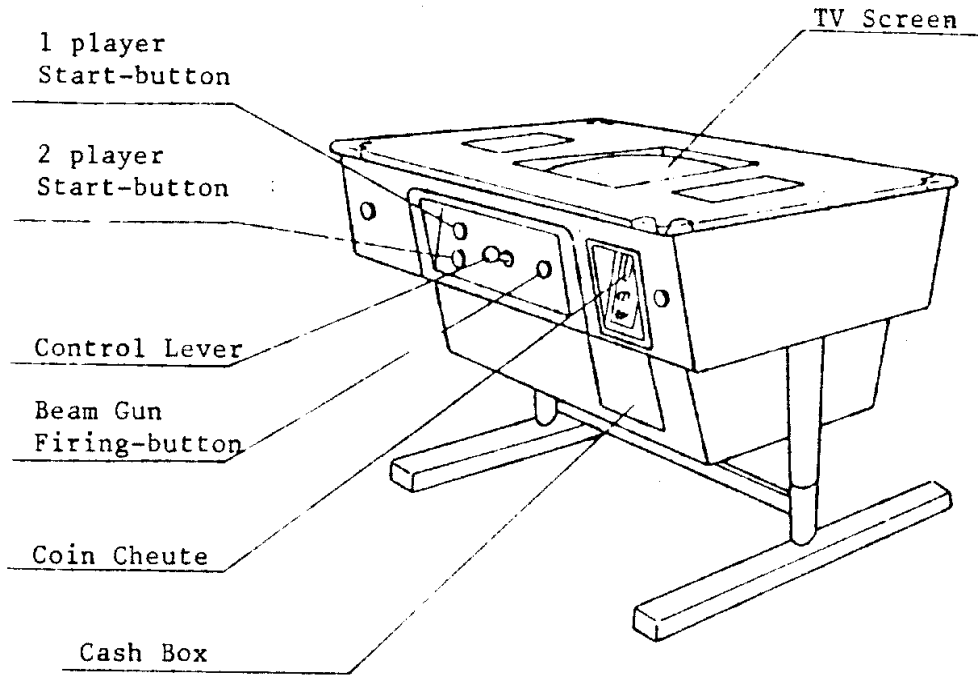

D. 1

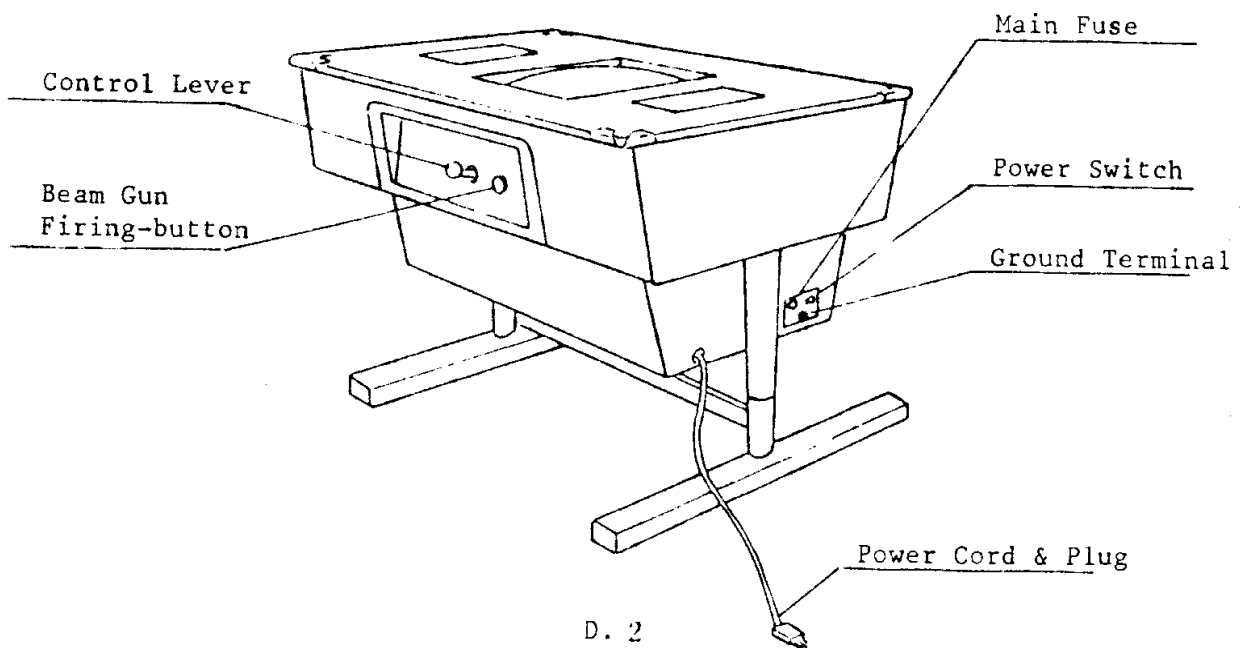

D. 2

INSTRUCTION ON HANDLING

\* Just be carefull not to put impact during transportation, transfer and removal, since monitor is built inside the machine

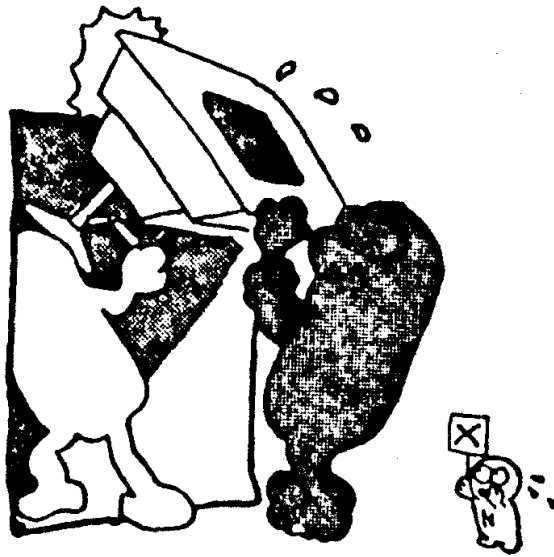

\* \* \* Install the machine inside house. \* \* \* Never put it outdoor.

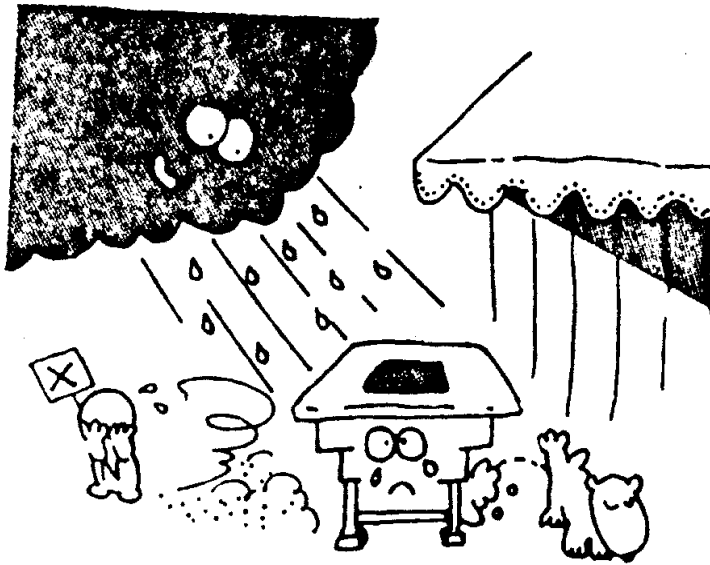

\* Do not install it on a vibrative place.

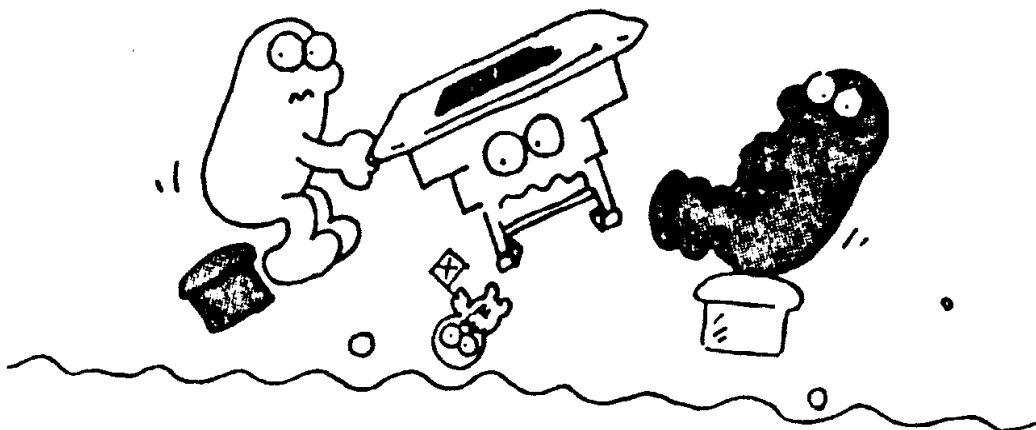

\* Do not install it under the sun, not at dusty and humid place, nor near heaters, to keep an inside temperature of the machine from going up.

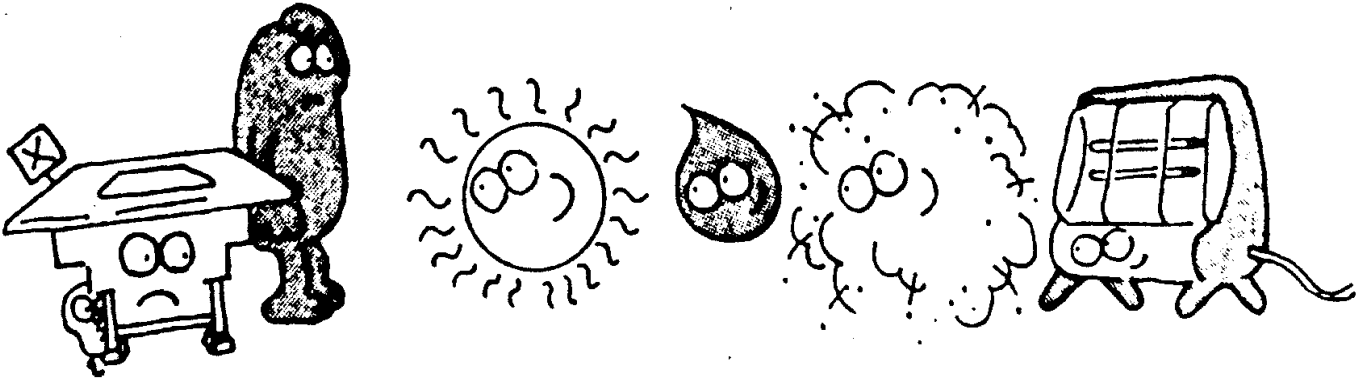

\* Do not install it near places where there are Emergency Exit, Fire Alarm and so on.

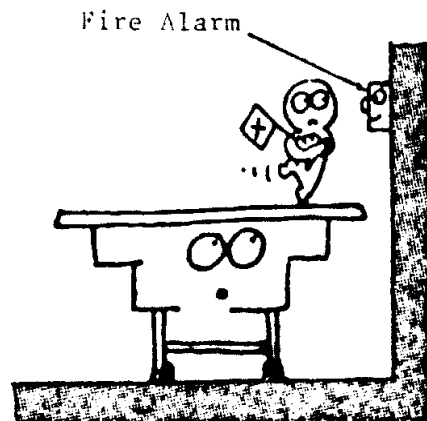
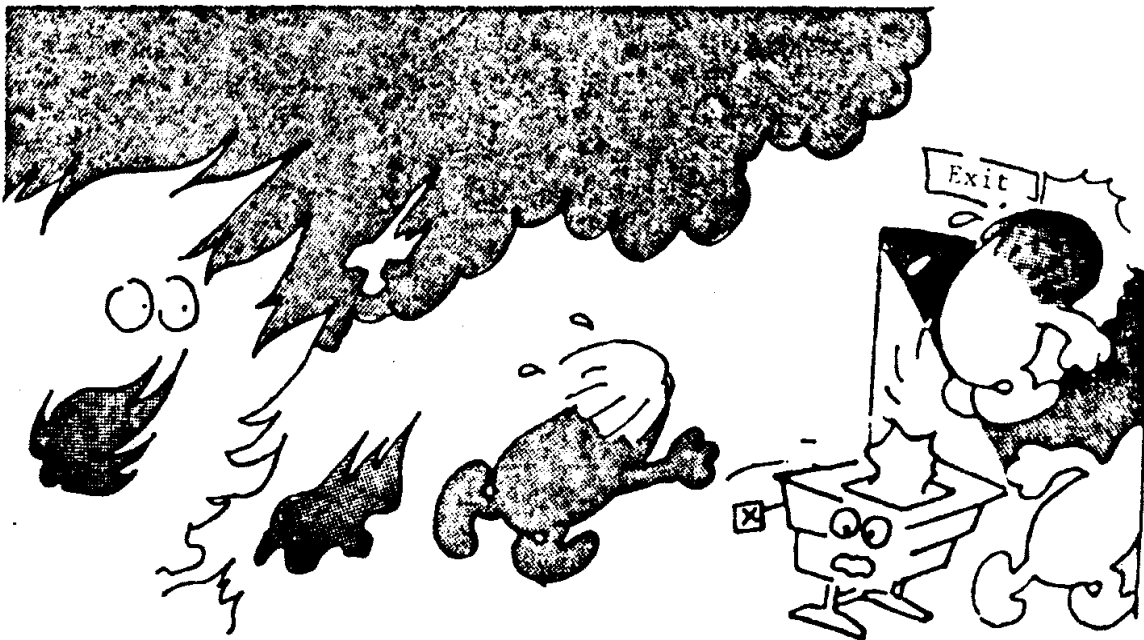

\* Connect the earth conductor with the earth terminal.

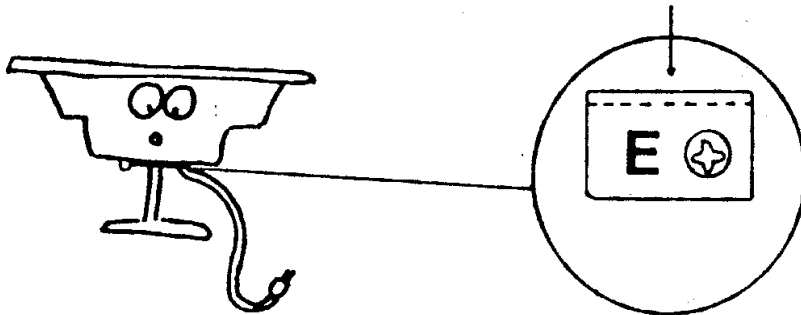

\* Make sure that connections and/or connectors of P. C. Board etc. are in good orders

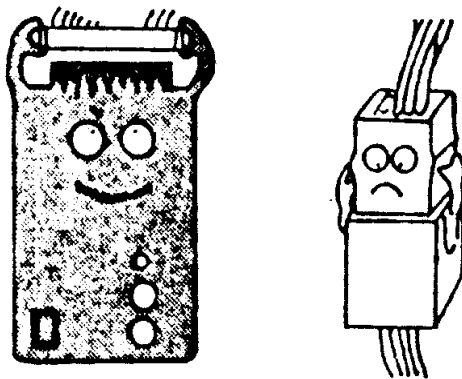

\* Power supply voltage : Never switch on to other power source(voltage) than the built-in power supply unit of the machine delivered.

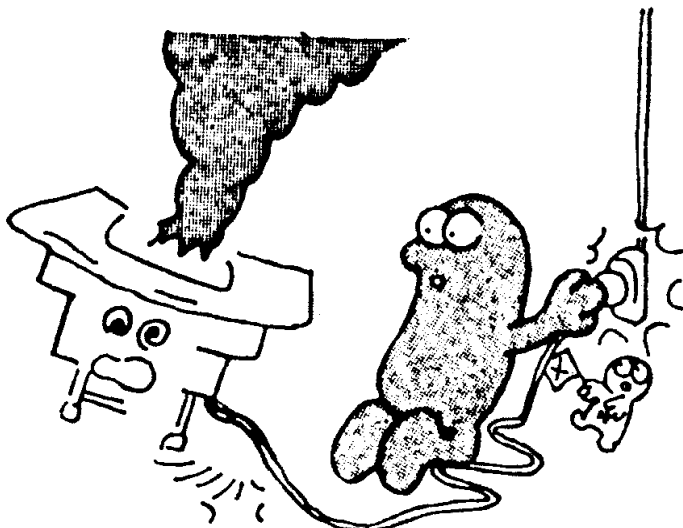

- \* Part of TV Monitor section is of High Voltage. Be careful.
- \* You will find sometimes part of picture pattern presented wrong on monitor when power switch is turned on in installation. This may happen because of special characteristics of C.P.U. You will get bright pattern picture when power switch is turned on again.

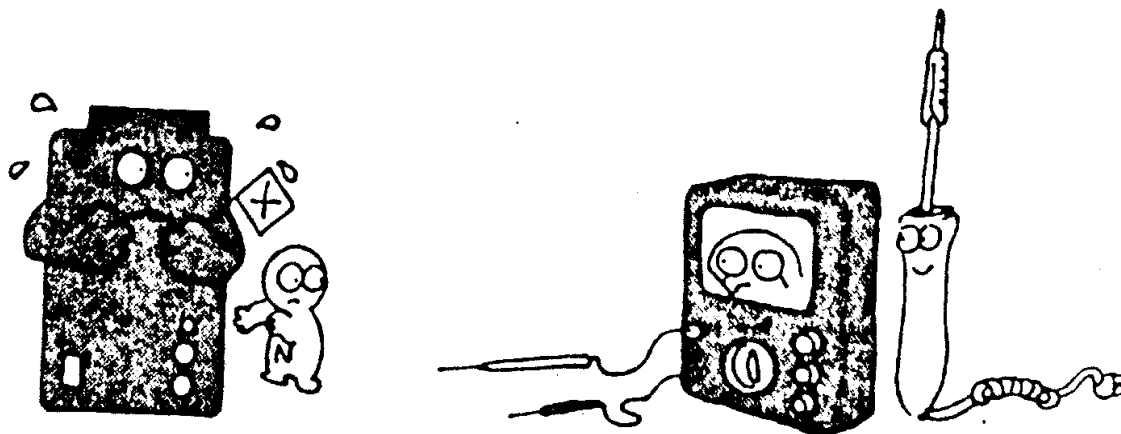

- \* The machine, combined IC and all-Transistor Video-Monitor based on C.P.U., can offer long life time, however, will be subjected to instant break and damage, depending on handling.

PAY ATTENTION: (1) Not to use Tester etc... for circuit inspection, should Solid State Module be found defective. Voltage inside Tester tends to disrupt IC function.

(2) To turn power switch off when you take in and out Solid State Module with socket.







- \* Do not pull the cord when you take the power supply plug out of the socket.
- \* Use a wrapper such as a vinyl air mat when you send it in a carton box.

## HOW TO PLAY

- \* One or two players can play it.
- \* One player can slot in one-mark coin for one game.  
Two players can do two mark for one game.  
You can use both one-mark and two-mark coin inlet.
- \* When you slot in a one-mark coin, 'CREDIT' on the screen will indicate '1'.  
When you put in a 'two'-mark coin, it will indicate '2'.
- \* Push a button showing 'ONE PLAYER' when you would like to play by yourself, but another button indicating 'TWO PLAYERS' when you do it together with somebody else.
- \* In the case of two players, take turn in playing it each time rocket is destroyed.
- \* By manipulating the control lever on the operating board to shift the rocket to the left or right and the firing button to send laser beams, destroy all of the enemy falling down.
- \* You will get points every time you shoot an enemy. The points will be on the top of the screen marked '1UP' , but another player showing '2UP'.
- \* Game is over when all three rockets are destroyed.
- \* If you succeed to do better than the required points, rockets 1, 2 and 3 are added.  
(When machine is delivered from factory, required points are set just 30,000.)
- \* When docking time flashes, use the control lever and firing button for reverse action to dock the rocket to the main rocket that will appear at the lower section of screen.

- \* The faster you are able to complete docking, the higher your points.
- \* When docking is complete, you get the advantage of repeated firing.

\* Points vary with what kind of enemys you shoot.

COLD EYE		50 POINTS
SUPER FLY		30 POINTS
FORTY		60 POINTS
METEOR		200 POINTS
ATOMIC PILE		100 POINTS
DOCKING		?

### \*\*\* Service Button

Use the service button for technical test. It will increase a number of credit, but the coin counter meter will not work.



## HOW TO ADJUST

As all machines will be delivered from factory after proper test and adjustment, there is little need of general re-adjustment works except for the following points.

(1) Setting of 'DIP-SWITCH'

'DIP-SWITCH' is on P. C. Board. A switch combination of 'ON' and 'OFF' will shift like this:

	SW 1	SW 2	SW 5	SW 6
GAME FEE 1PLAY/1MARK 2PLAY/1MARK 3PLAY/1MARK FREE PLAY			<u>OFF</u> ON OFF ON	<u>OFF</u> OFF ON ON
BONUS SCORE 30,000 50,000	<u>OFF</u> ON			
JAPANESE ENGLISH		OFF <u>ON</u>		

- \* DIP-SWITCH No.3, 4 are to be off.
- \* Switch will be set as underlines when the machine are delivered from factory.
- \* IMPORTANT  
Switch 'OFF' the power supply first when you use 'DIP-SWITCH'.

(2) How to Adjust Sound Volume

Turn up or down the volume fixed on P. C. Board, in case the sound adjustment is necessary.

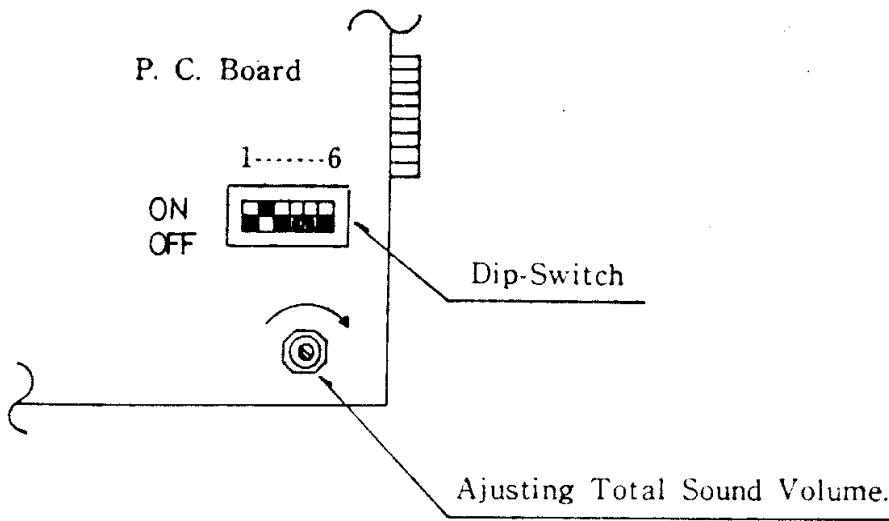

\* The screw will be turned clockwise to increase sound volume.

# CABINET ACCESSORY AND TABLE TOP BOARD ASS'Y

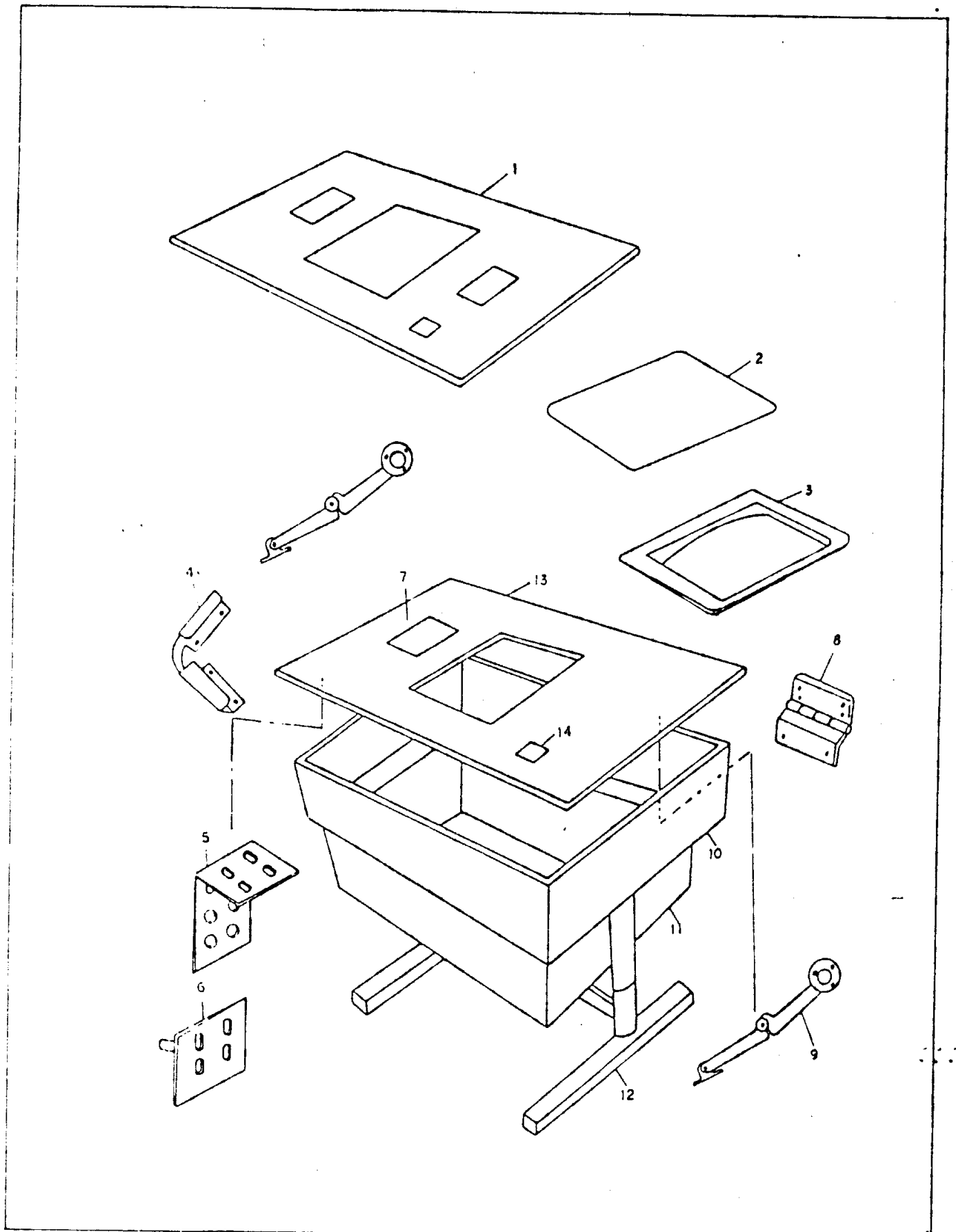

# VIDEO AND CABINET ASS'Y

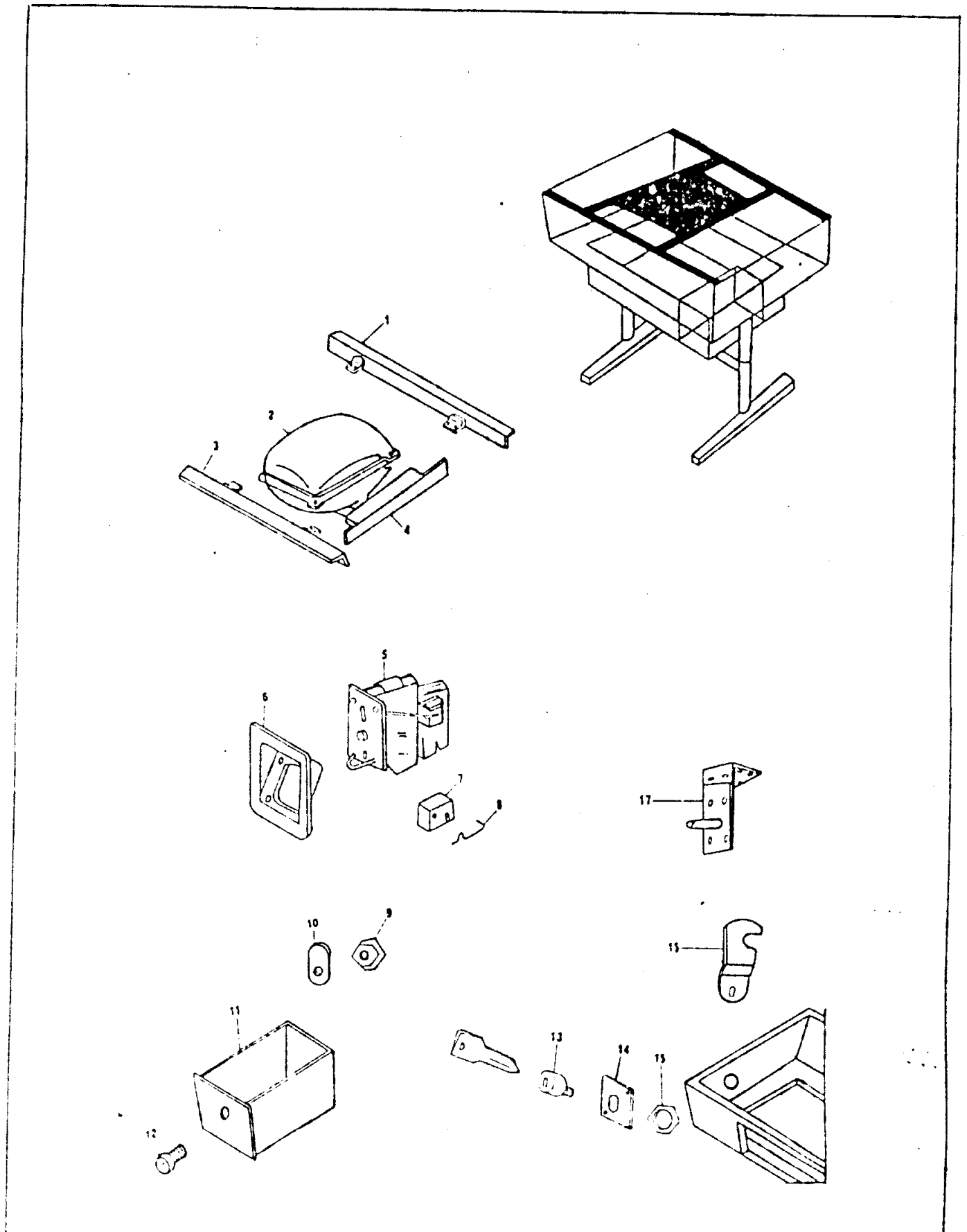

# PRINTED BOARD AND REGULATOR ASS'Y

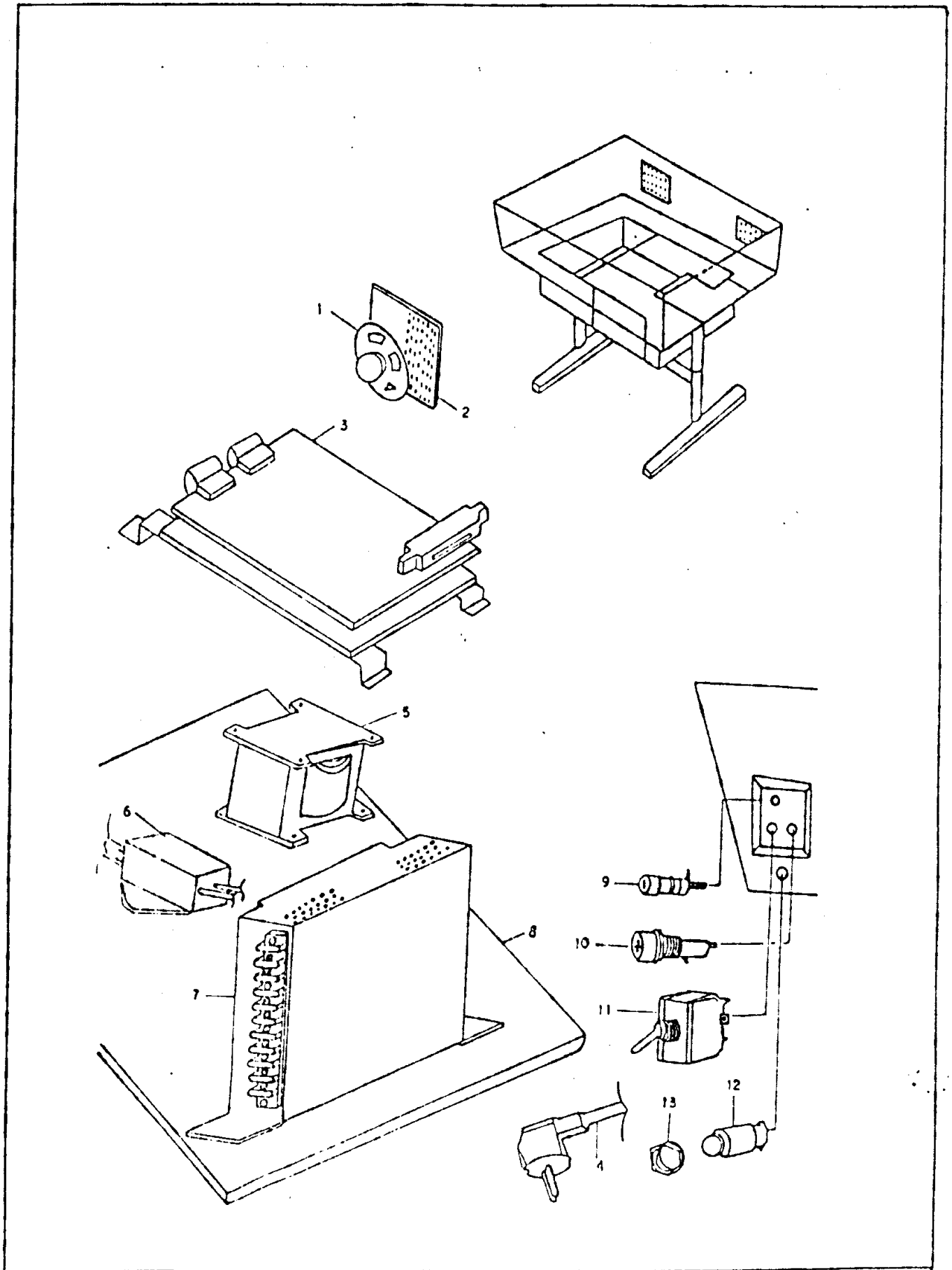

# CONTROL PANEL ASS'Y

( A )

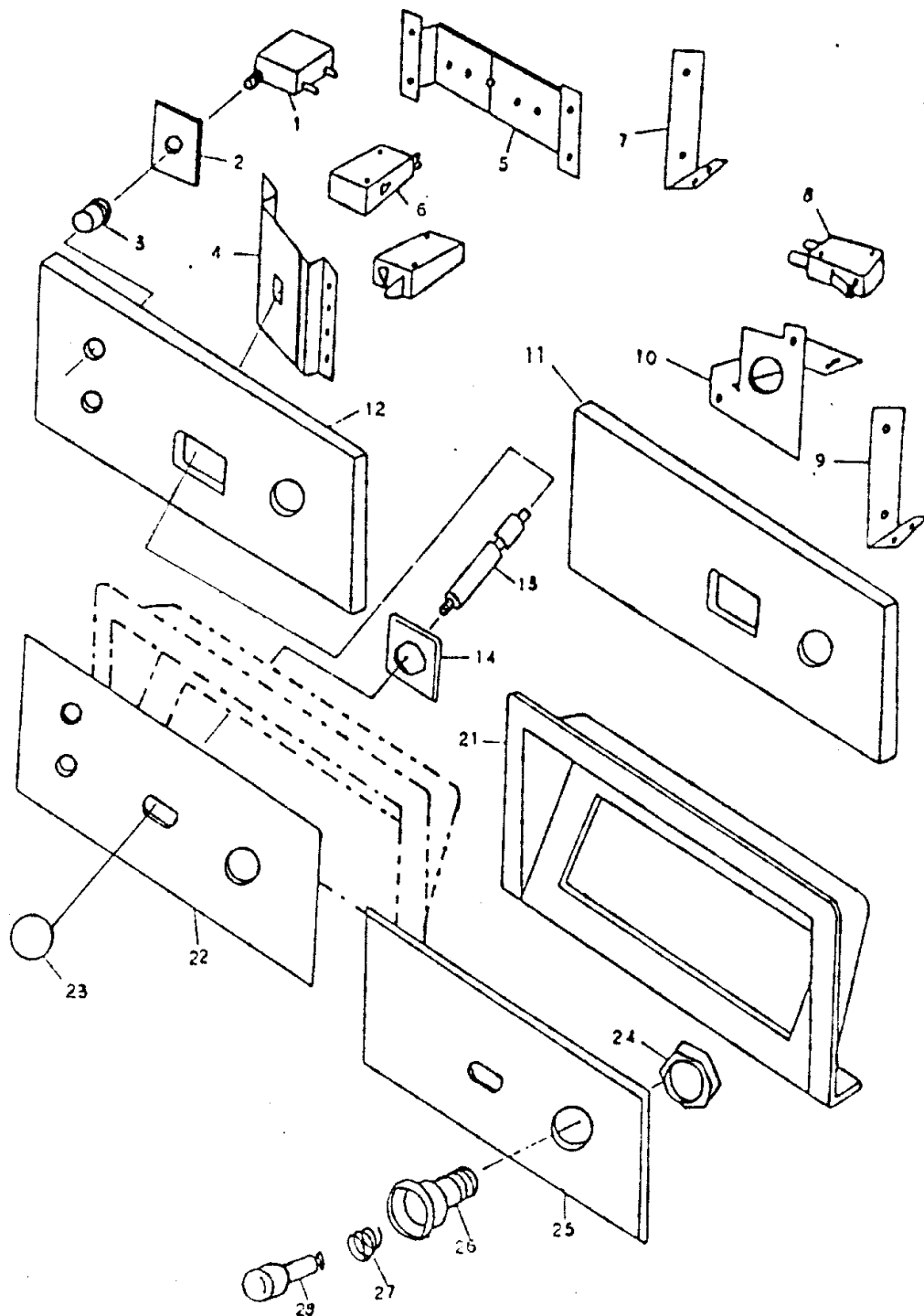

# CONTROL LEVER ASS'Y

( 2W )

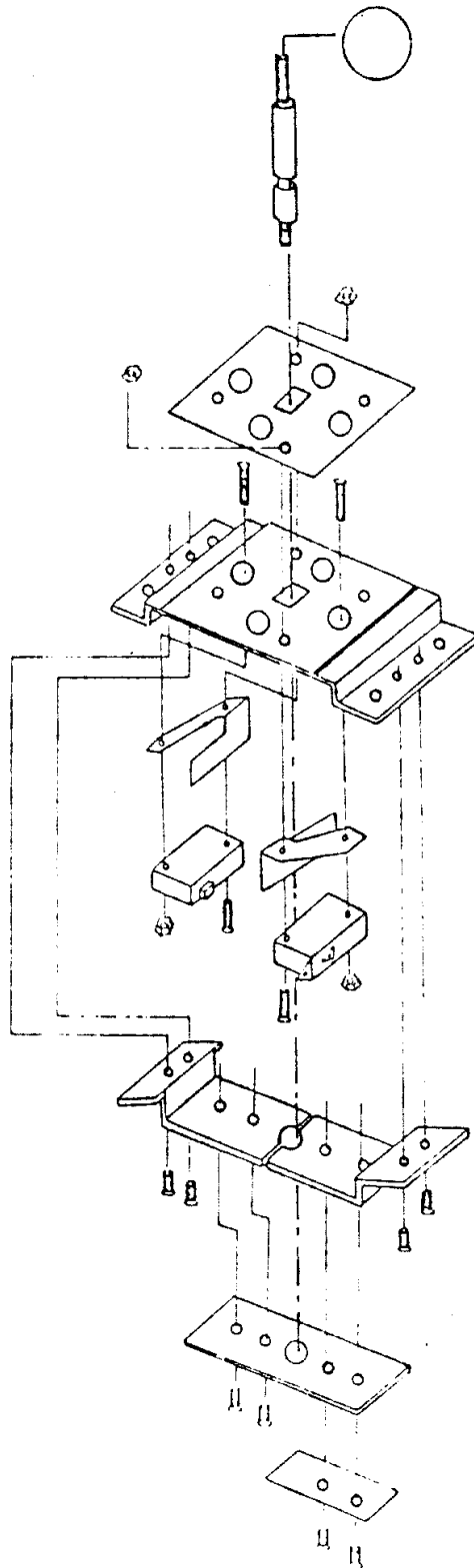

\* CABINET ACCESSORY AND TABLE TOP BOARD ASS'Y

Item	Description
1	Table Top Glass
2	Smoked Acryl Plate
3	Video Escutcheon
4	Corner Bracket
5	Lock Bracket (A)
6	Lock Bracket (B)
7	Instruction Card
8	Hinge Ass'y (A)
9	Hinge Ass'y (B)
10	Table Upper Box
11	Table Bottom Box
12	Table Leg
13	Top Board
14	Coin Sticker

\* VIDEO AND CABINET ASS'Y

1	Support Bracket (A)
2	Video
3	Support Bracket (B)
4	Video Bracket
5	Coin Rejector
6	Rejector Mounting Bracket
7	Micro Switch
8	Actuator
9	Lock Washer (A)
10	Lock Plate
11	Cash Box
12	Lock & Key
13	Service Lock & Key
14	Lock Holding Plate
15	Lock Washer (B)
16	Lock Lever
17	Lock Plate



\* PRINTED BOARD AND REGULATOR ASS'Y

Item	Description
1	Speaker
2	Punching Metal
3	Main P.C Board
4	AC Cable & Plug Ass'y
5	Transformer
6	Noise Filter
7	Switching Regulator
8	Transformer Mounting Plate
9	Earth Terminal
10	Fuse Holder
11	Toggle Switch
12	Molded Cord Bush
13	Washer

## \* CONTROL PANEL ASS'Y

( A )

Item	Description
1	Micro Switch (A)
2	Switch Plate
3	Push Button
4	M.S. Mounting Bracket
5	Base Bracket
6	Micro Switch (B)
7	Control Board Bracket
8	Micro Switch (C)
9	Control Board Bracket
10	Push Button Bracket
11	Control Board (A)
12	Control Board (B)
13	Lever
14	Mask Plate
21	Control Panel
22	Control Plate (A)
23	Color Ball
24	Washer
25	Control Plate (B)
26	Push Button Housing
27	Spring
28	Push Button

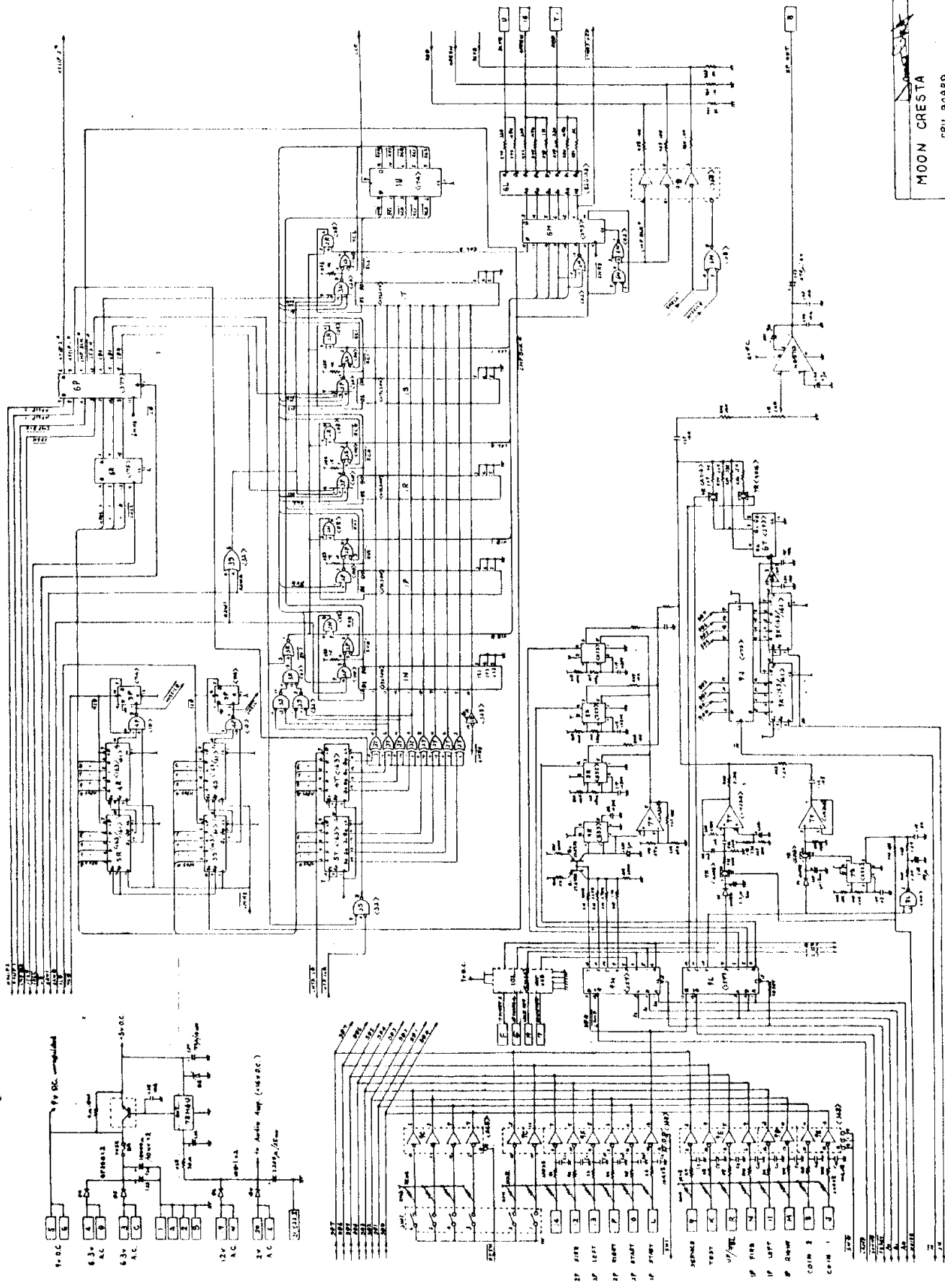

MOON CRESTA  
CPU BOARD

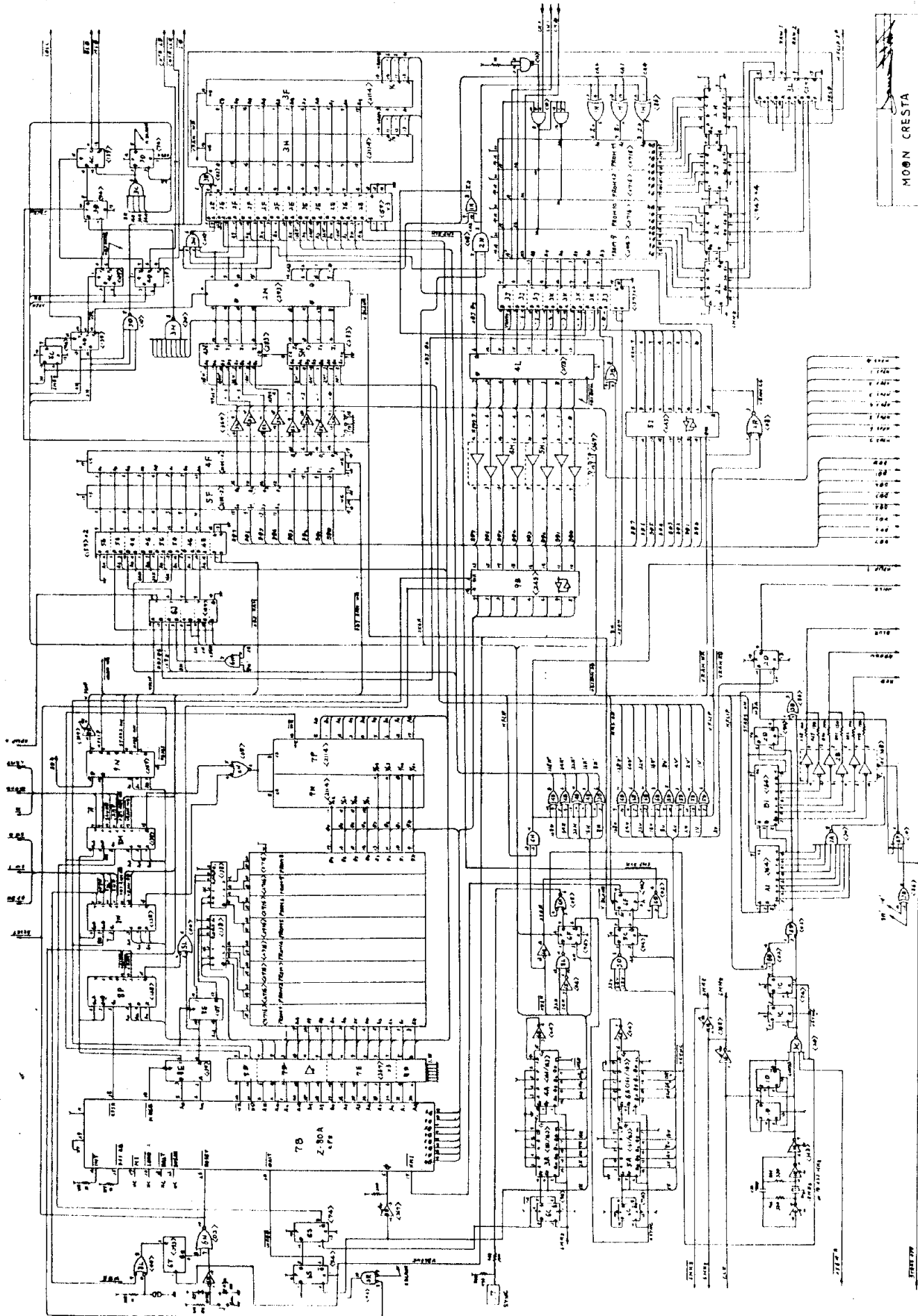

MOON CRESTA  
CPU BOARD





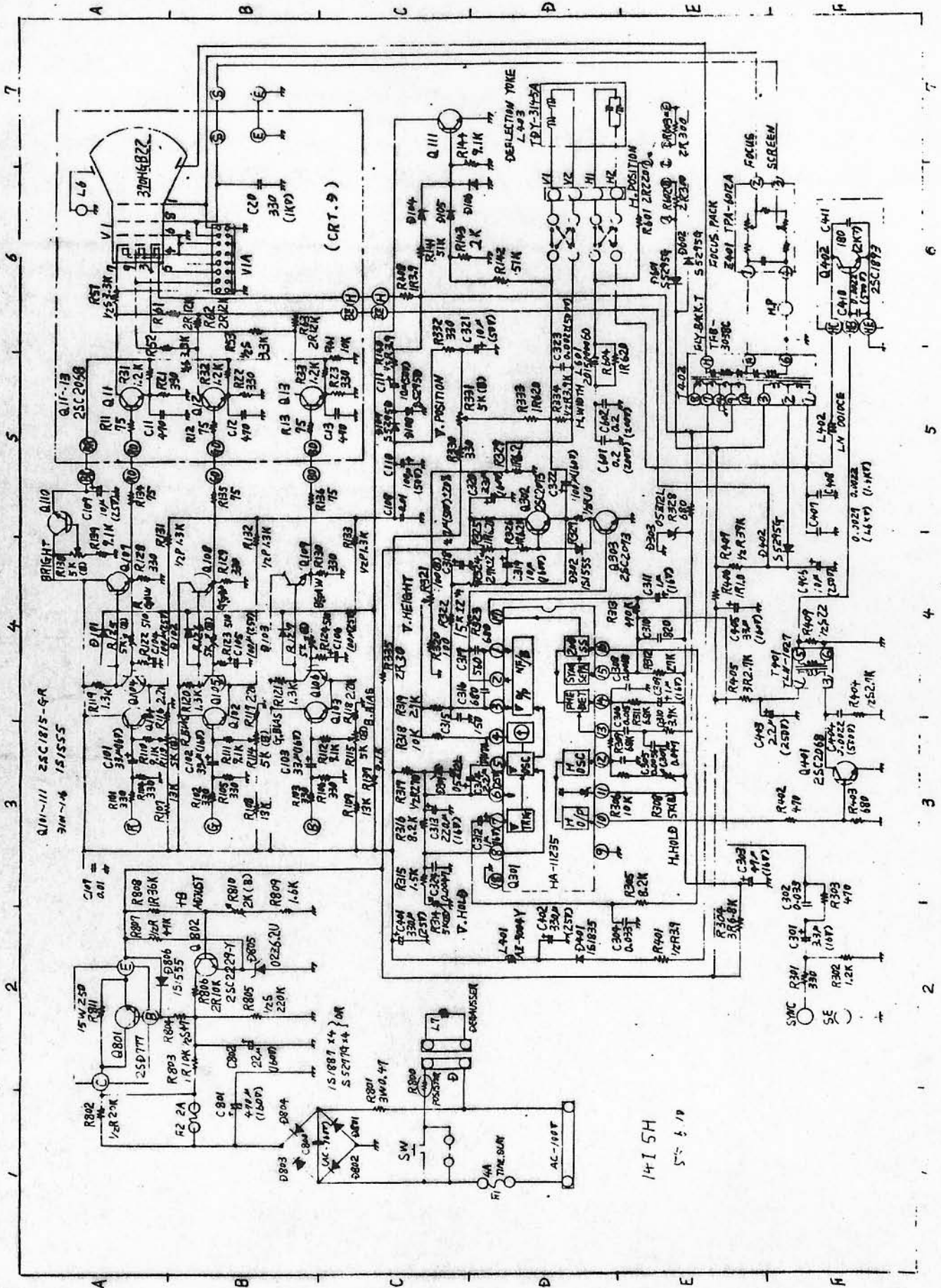

14" TV MONITOR SCHEMATICS, MOON CRESTA

1415H  
S-5-10